

WL500 DRAWINGS and PARTS LIST

Yellow = Consumables
 Green = Recommended spare parts

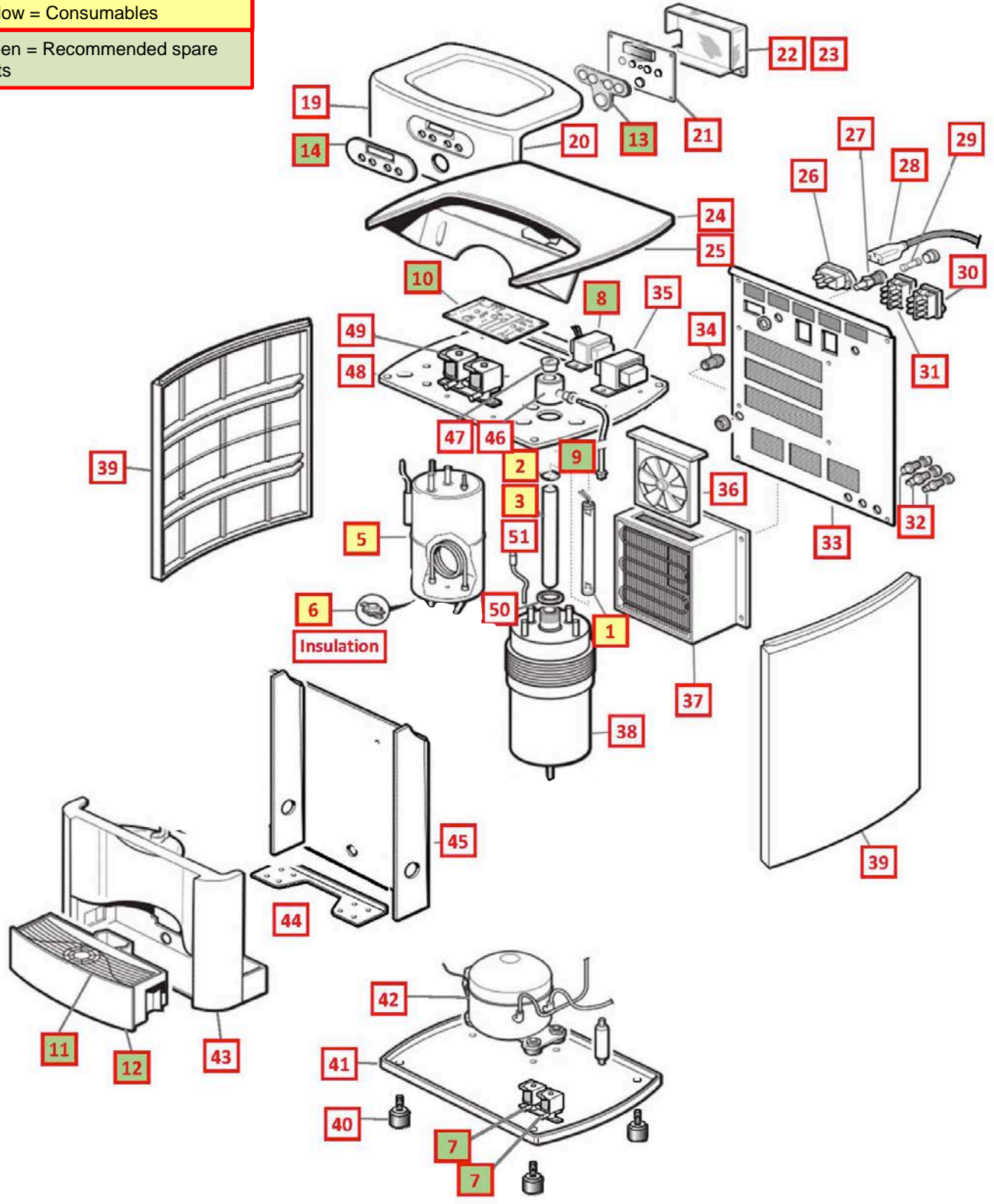

WETTED PARTS

Yellow = Consumables
Green = Recommended spare parts

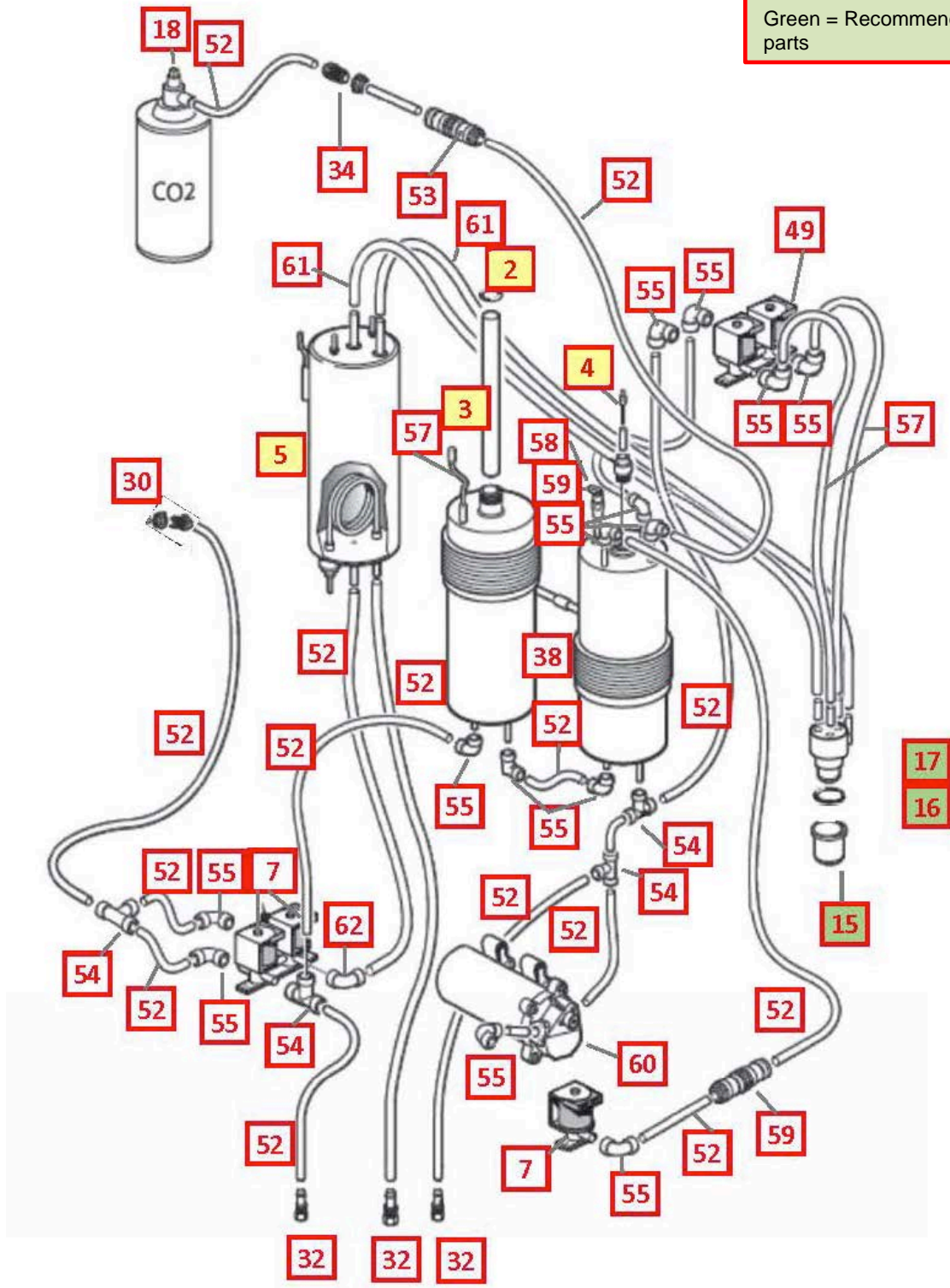

No	WLCP PN	Description	Factory PN	Stocked?	
Consumables					
1	10-7020	UV Lamp Assembly with Glow Starter	CT-2045	Yes	
2	10-2500	Black O-Ring for Quartz Sleeve	CT-2006	Yes	
3	10-1400	Quartz Sleeve for 8W Lamp	CT-2002	Yes	
4	10-7250	Sparkling Level Probe Assembly	CT-2036-L00-00	Yes	
5	10-7082	Stainless Tube Hot Tank 1.6 Liter	HT-3021	Yes	
6	12-1360	Hot Tank Overload – Reset	HT-3012	Yes	
Not Shown	01-2076	Scale Kleen	NA	Yes	
Recommended Spare Parts					
7	12-1500	Solenoid Valve <i>Recommend stocking 1 each for every 10 units purchased</i>	PU-4016	Yes	
8	10-3010	UV Lamp Ballast 110V/60Hz <i>Recommend stocking 1 each for every 10 units purchased</i>	EL-5006-A CN	Yes	
9	10-3011	UV Lamp Sensor (CDS) with wire <i>Recommend stocking 1 each for every 10 units purchased</i>	EL-5007	Yes	
10	10-7090	Main PCB <i>Recommend stocking 1 each for every 10 units purchased</i>	EN-6067-A	Yes	

11	12-8150	Drip Tray Grill – Charcoal <i>Recommend stocking 2 each for every 10 units purchased</i>	PL-1152	Yes	
12	10-7074	Charcoal Drip Tray Body – Waterlogic Logo <i>Recommend stocking 2 each for every 10 units purchased</i>	PL-1253-CN	Yes	
12.1	10-7092	Drip Tray Harness <i>Recommend stocking 1 each for every 10 units purchased</i>	EL-5041	Yes	
12.2	10-4006	Drip Tray Body Clip (Metal) <i>Recommend stocking 2 each for every 10 units purchased</i>	EN-6038	Yes	
12.3	10-7057	Drip Tray Sensor & Retaining Bracket <i>Recommend stocking 2 each for every 10 units purchased</i>	ST-8102	Yes	
13	10-7225	Silicon Button Key Mat <i>Recommend stocking 1 each for every 10 units purchased</i>	PL-1098	Yes	
14	10-7077	Display Label <i>Recommend stocking 1 each for every 10 units purchased</i>	PL-1102	Yes	
15	10-3048	Faucet Nipple – Blue with Screen <i>Recommend stocking 1 each for every 10 units purchased</i>	PL-1013	Yes	
16	10-2600	Natural Faucet O-Ring – Silicon White <i>Recommend stocking 1 each for every 10 units purchased</i>	CT-2007	Yes	
17	12-5235	Faucet - 3-way <i>Recommend stocking 1 each for every 10 units purchased</i>	PL-1212-CN	Yes	
18	AK-0003-L00	CO2 Pressure Regulator with tamper proof adjuster, preset to 35-45 psi, single output pressure gauge, inline shut-off valve, ¼ quick connect fitting, safety relief, and CO2 CGA-320 thread adapter. <i>Recommend stocking 1 each for every 10 units purchased</i>	AK-0003-I00-00	Yes	

Remainder of Parts					
18.1	NA	C02 Pressure Regulator O-Ring	10-7036	Yes	
19	10-7070	Front Door Panel Charcoal <i>Sold Separately: Display Label P/N 10-7077 Silicon Button Key Matt P/N 10-7225</i>	PL-1092	Yes	
20	10-7069	Door Lock Bracket – Lower	ST-8104	No	
21	10-7210	Display PCB <i>*Use for replacement even on older units that may have a different Display PCB.</i>	EN-6073-A	Yes	
22	10-7096	Display PCB Cover	PL-1119	Yes	
23	10-7068	Hatch Panel Locking Stanchion	ST-8103	Yes	
24	10-7073	Top Cover Charcoal	PL-1095	Yes	
25	10-7265	Electronics Cover Bracket <i>Under Top Cover</i>	ST-8278	Yes	
26	10-4013	Power Line Noise Filter, ElectroMagnetic Interference Filters (EMI)	EL-5016	Yes	
27	10-3014	Fuse Holder and Fuse 120V / 15A with One Wire	EL-5053	Yes	
28	10-3007	Power Cord 120V - 1840 mm	EL-5001-B	Yes	

29	10-3013	Fuse 120V / 15A	EL-5010	Yes	
30	10-3009	GREEN Heater/Compressor Switch	EL-5005	Yes	
31	10-3008	RED Power Switch	EL-5004	Yes	
32	14-5011	Drain valve 5/16"	CT-2031-A	Yes	
32.1	NA	Drain Valve Clamp 5/16"	CT-2046	No	
33	10-7051	Back Panel	ST-8094-A	No	
34	10-3067	Bulkhead Union 1/4" x 1/4" John Guest P/N PI1208S	PU-4028-A	Yes	
35	10-7220	Power Transformer for Sparkling	EL-5094	Yes	
36	10-1500	Fan Motor 110V (AC Axial fan)	CT-2011	Yes	
36.1	NA	Fan Bracket	ST-8227	No	
37	10-7081	Cooling Fan Condenser	CO-9023A	Yes	

38	NA	Cold Tank Assly-4L Sparkling. Double Tank	CT-2032-A	No	
39	10-7072	Side Panel Silver	PL-1094	Yes	
39.1	NA	Frame Bracket - Gray Plastic	PL-1135	No	
40	10-3083	Adjustable Unit Rubber Feet	ST-8016	Yes	
41	10-7053	Bottom Shelf	ST-8096	Yes	
42	10-2200	Compressor (R134a 1/8HP) 120V/60Hz	CO-9001-A	Yes	
42.1	10-3003	Compressor Starter Relay	CO-9016	Yes	
42.2	10-5018	Compressor Overload	CO-9015	Yes	
43	10-7071	Front Panel for Drip Tray Insert Silver – <i>when purchasing, also request Hot Water Caution Label LP-7169 / 12-0001 to adhere to front of this Panel.</i>	PL-1093	Yes	
43.1	12-0001	Hot Water Caution Label – adhere to Front Upper Drip Tray Insert Panel	LP-7169	Yes	
44	10-7054	Filter Housing Bracket	ST-8097	Yes	

45	10-7050	Metal Front Frame Panel	ST-8093	Yes	
46	10-4008	UV Lamp Retaining Nut	PL-1027	Yes	
47	10-3095	CDS Fixing Rubber (Silicon)	CT-2010	Yes	
48	10-7052	Upper Shelf - Inner	ST-8095	No	
49	10-7060	Double Solenoid Valve with wire harness assembled	PU-4056-B	Yes	
50	10-3096	Cold Tank Retaining Nut	CT-2001-C	Yes	
51	10-2650	Cold Water Sensor	CT-2057	Yes	
52	Purchase from John Guest	JG LLD PE Tube - Blue O.D.1/4"John Guest P/N PE-08-BI-1000F-B	PU-4031-A	No	
53	Purchase from John Guest	JG Equal Straight Connector 1/4"(PI0408S)	PU-4010	No	
54	Purchase from John Guest	1/4" Union Tee John Guest P/N P10208S	PU-4011-A	No	
56	Purchase from John Guest	1/4" Union Elbow John Guest P/N P10308S	PU-4008-A	No	

57	Purchase from John Guest	JG LLD PE Tube - Blue O.D.1/4" John Guest P/N PE-08-BI-1000F-B	PU-4031-A	No	
58	10-7245	Upper Safety Valve 1/4" for Sparkling Unit	CT-2037-100-00	Yes	
58.1	NA	Silicon O-Ring for Upper Safety Valve (Red)	PL-1271	No	
59	10-7270	JG Non-Return Valve 1/4"(1/4SCV)	PU-4057	Yes	
60	10-7235	Booster Pump - Sparkling	CT-2035-E	Yes	
60.1	10-7240	Pump Bracket	ST-8098	Yes	
61	10-7040	Silicon Tube 5/16" for Hot Water	PU-4064	Yes	
62	Purchase from John Guest	5/16" x 1/4" Reducing Elbow John Guest P/N PI211008S	PU-4007-A	No	
63	12-8006	Hot Tank Fixing Bracket 400mm for 1.5L	ST-8120	Yes	
Not shown	10-3007	Power Cord 120V – 1840 mm	EL-5001-B	Yes	